

CHESTNUT X lite

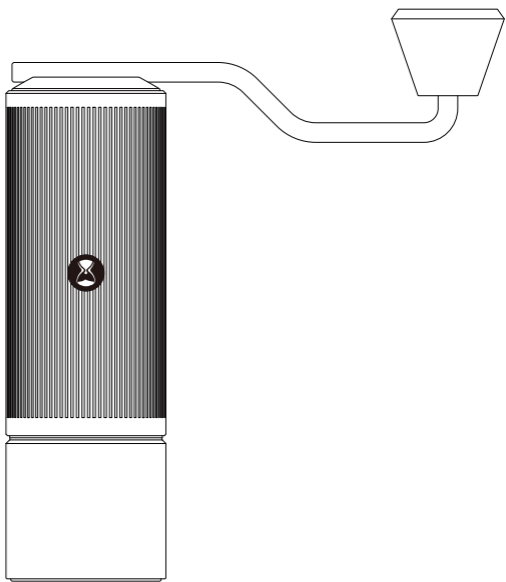

TIMEMORE CHESTNUT X lite
MANUAL COFFEE GRINDER
User Manual

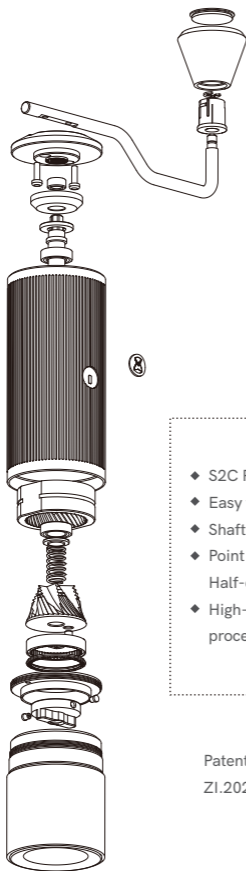

- ◆ S2C Patent Original design burrs
- ◆ Easy to hold Ergonomics design
- ◆ Shaft fixed by dual ball bearings
- ◆ Point to Point structure for patented Half-click coarseness adjustment
- ◆ High-precision Uni-body CNC processing

Patent number:

ZI.202130872322.6

Parts & Functions

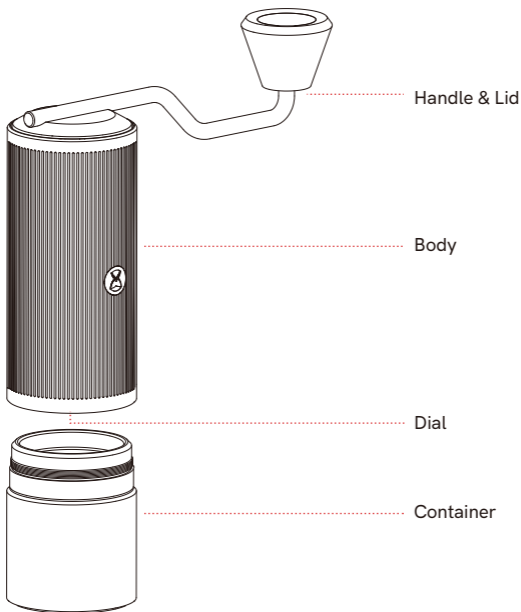

BODY: Aluminum Alloy 6061

CONTAINER: Aluminum Alloy 6061

KNOB: Aluminum Alloy 6061

HANDLE: Austenitic Steel(SUS304)

CENTRAL SHAFT: Austenitic (SUS304)

BURRS: Martensitic Steel(SUS440)

LOGO: Aluminum Oxidation

How to Use

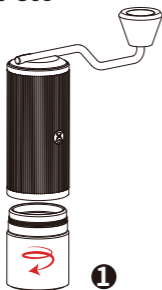

Take off the container and cover the handle. Hold the container and the main body. Adjust the adjustment dial to the desired grind. See the next page to see how to adjust the coarseness

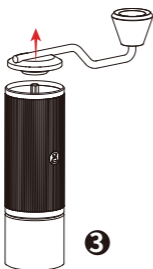
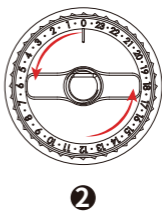

Put back the container, open the lid and load coffee beans into the bean chamber.

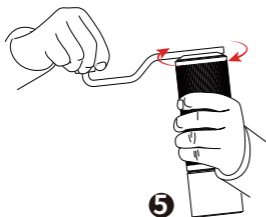

Put the lid back. Hold the main body and rotate the crank handle clockwise until all beans are grounded. Take off the container for grounded coffee.

How to Adjust

Below picture is adjustment Plate.

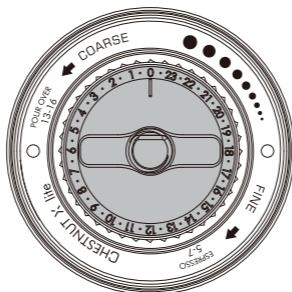

- ◆ This position 0 click is the Start Point.
- ◆ 0 Click is the finest coarseness. The higher, the coarser.
- ◆ Recommended clicks for different brew ways

Recommended Coarseness for
different Extraction ways
(Based on START POINT)

ESPRESSO 5-7 Clicks

POUR OVER 13-16 Clicks
(Recommended 15 Clicks)

FRENCH PRESS 17-22 Clicks

Tips for Adjustment

- ◆ Cover the lid before you adjust the coarseness.
- ◆ DO NOT grind between 0-3 clicks which may damage the burrs.
- ◆ Keeping rotating the lid to the end will make the inner burr come out from the body.

Caution

- ◆ Please grind roasted coffee beans only instead of any other things.
- ◆ Please clean the device with a brush or air blower. DO NOT clean it with any liquid including water.
- ◆ Watch out for the sharp burrs which may cause cuts and scratches. Please do not touch it.
- ◆ Children are not allowed to operate the device alone.
- ◆ Store the device in a cool and dry place.
- ◆ It is NOT recommended to disassemble or replace the burr or other internal parts by yourself. If you have any special needs, please contact professionals for advice.

Troubleshooting

- ◆ Q: Why does the dial no longer correspond to 12 clicks instead of 0 click clockwise to the limit?
A: Please remove the dial and install the dial from opposite direction. Please re-calibrated the dial if you reinstall.
- ◆ Q: Why does the grinding consistency get decreased?
A: 1.Check if any part gets damaged. If yes, kindly replace it.
2.Check if you disassemble the out burr and get it deviated. If yes, kindly reinstall and adjust it.

Please contact your seller for help if you have any question please.

CHESTNUT

泰摩栗子X lite咖啡豆研磨器

TIMEMORE CHESTNUT X lite MANUAL COFFEE GRINDER

TIMEMORE Coffee specializes in
original specialty coffee equipment.
With Philosophy of Profession and Aesthetics
Create valuable coffee equipment
Let's enjoy slow living with more time

CONTACT

✉ info@timemore.com

www.timemore.com



@TIMEMORECOFFEE